

PARKING SYNOPSIS

TENANT NAME	APPROX. GLA	PROVIDED PARKING	
LADCO	18,826 S.F.	38 CARS	2.0/1000
FRANKEL	5,000 S.F.	13 CARS	2.6/1000
POMOGRANIT	11,559 S.F.	46 CARS	4.0/1000
LEVCOR	7,346 S.F.	18 CARS	2.5/1000
4M INVESTMENTS	3,741 S.F.	10 CARS	2.6/1000
RETAIL/OFFICE	2,396 S.F.	10 CARS	4/1000
VISION-WOOD	1,697 S.F.	7 CARS	4/1000
AVAILABLE	12,191 S.F.	49 CARS	4/1000
GROSS LEASEABLE	62,756 S.F.		
CORRIDORS & COMMON AREAS	4,182 S.F.		
TOTAL BLDG. AREA	66,938 S.F.		
PROVIDED CARS		213 CARS	3.2/1000

DEVELOPMENT SYNOPSIS

TOTAL LAND AREA	(± 4.801 AC.)	± 209,132 S.F.	
TOTAL GLA		66,938 S.F.	
OFFICE	2.5/1000	66,938 S.F.	167 SPACES
SMALL RESTAURANT	8/1000	0 S.F.	0 SPACES
TOTAL PARKING REQUIRED			167 SPACES
PARKING RATIO REQUIRED			2.5 /1000
TOTAL PARKING PROVIDED			213 SPACES
PARKING RATIO PROVIDED			3.2 /1000
DENSITY			33.7 %
SP-04	02-04-19	2018-135.001	

THIS DRAWING IS FOR INFORMATION PURPOSES ONLY. ANY AND ALL FEATURES, MATTERS OTHER INFORMATION DEPICTED HEREON OR CONTAINED HEREIN ARE FOR ILLUSTRATIVE MARKETING PURPOSES ONLY. ARE SUBJECT TO MODIFICATION WITHOUT NOTICE. ARE NOT INTENDED TO BE RELIED UPON BY ANY PARTY AND ARE NOT INTENDED TO CONSTITUTE REPRESENTATIONS AND WARRANTIES AS TO THE SIZE AND NATURE OF IMPROVEMENTS TO BE CONSTRUCTED (OR THAT ANY IMPROVEMENTS WILL BE CONSTRUCTED) OR AS TO THE IDENTITY OR NATURE OF ANY OCCUPANTS THEREOF.

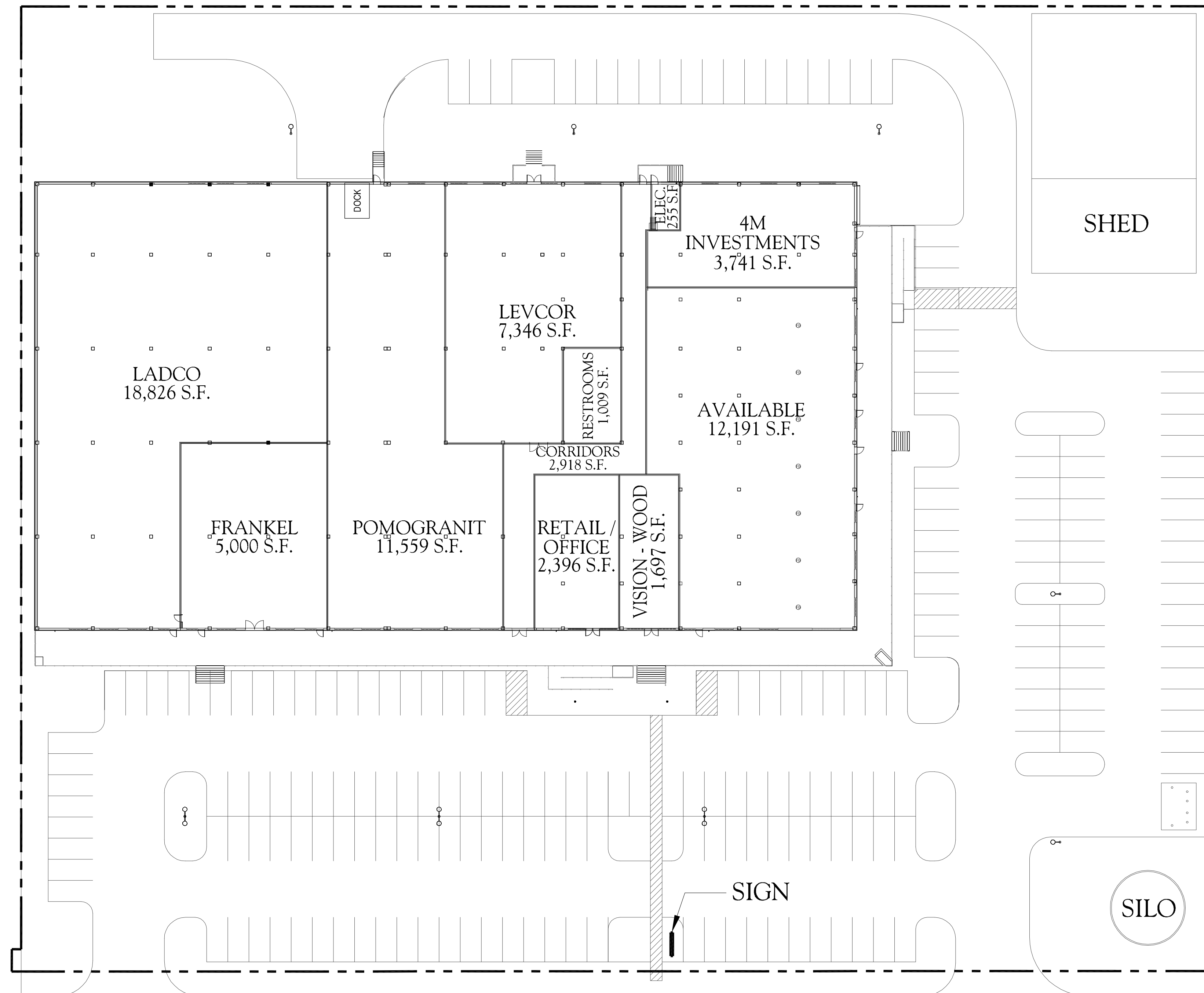

1"=30'

N



7800 WASHINGTON
 PRELIMINARY SITE PLAN
 7800 WASHINGTON AVE.
 HOUSTON, TEXAS