

W. POLK AVENUE

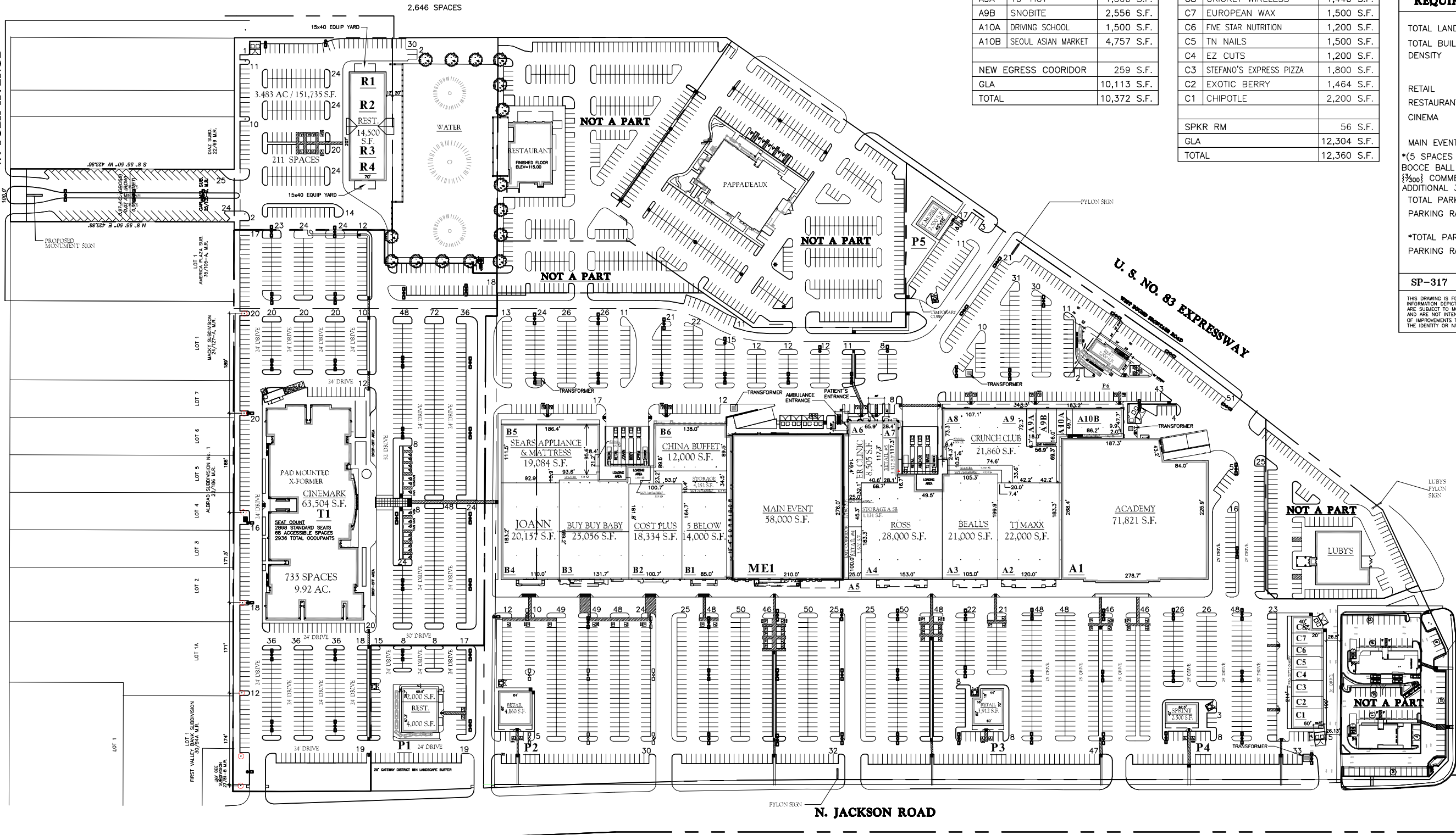

BUILDING 'A9' - 'A10' TOTALS		
A9A	10' HUT	1,300 S.F.
A9B	SNOBITE	2,556 S.F.
A10A	DRIVING SCHOOL	1,500 S.F.
A10B	SEOUL ASIAN MARKET	4,757 S.F.
NEW EGRESS COORIDOR 259 S.F.		
GLA		10,113 S.F.
TOTAL		10,372 S.F.

BUILDING 'C' TOTALS		
C8	CRICKET WIRELESS	1,440 S.F.
C7	EUROPEAN WAX	1,500 S.F.
C6	FIVE STAR NUTRITION	1,200 S.F.
C5	TN NAILS	1,500 S.F.
C4	EZ CUTS	1,200 S.F.
C3	STEFANO'S EXPRESS PIZZA	1,800 S.F.
C2	EXOTIC BERRY	1,464 S.F.
C1	CHIPOTLE	2,200 S.F.
SPKR RM		56 S.F.
GLA		12,304 S.F.
TOTAL		12,360 S.F.

DEVELOPMENT SYNOPSIS REQUIREMENTS PER CITY OF PHARR, TEXAS			
TOTAL LAND AREA	(±48.60 AC.)	±2,117,295 S.F.	
TOTAL BUILDING AREA (GLA ONLY)			466,796 S.F.
DENSITY			22.0 %
RETAIL	305,328 S.F. (3 +1/300 S.F.)	1021 SPACES	
RESTAURANTS	39,964 S.F. (1/100 S.F.)	400 SPACES	
CINEMA	63,504 S.F. 2,936 SEATS (1/4 SEATS)	734 SPACES	
MAIN EVENT	58,000 S.F.	476 SPACES	
*(5 SPACES PER LANE {28 BOWLING LANES AND 4 BOCCIE BALL LANES}, PLUS 3/100 FOR RESTAURANT, {300} COMMERCIAL AND OFFICE; PLUS 1 FOR EACH ADDITIONAL 300 GFA)			
TOTAL PARKING REQUIRED			2,631 SPACES
PARKING RATIO REQUIRED			5.6 /1000
*TOTAL PARKING PROVIDED 2,646 SPACES			
PARKING RATIO PROVIDED 5.7 /1000			
SP-317	06- 04- 2018	2008-312.009	

THIS DRAWING IS FOR INFORMATION PURPOSES ONLY. ANY AND ALL FEATURES, MATTERS OTHER INFORMATION DEPICTED HEREON OR CONTAINED HEREIN ARE FOR ILLUSTRATIVE MARKETING PURPOSES ONLY, ARE SUBJECT TO MODIFICATION WITHOUT NOTICE, ARE NOT INTENDED TO BE RELIED UPON BY ANY PARTY AND ARE NOT INTENDED TO CONSTITUTE REPRESENTATIONS AND WARRANTIES AS TO THE SIZE AND NATURE OF IMPROVEMENTS TO BE CONSTRUCTED (OR THAT ANY IMPROVEMENTS WILL BE CONSTRUCTED) OR AS TO THE IDENTITY OR NATURE OF ANY OCCUPANTS THEREOF.

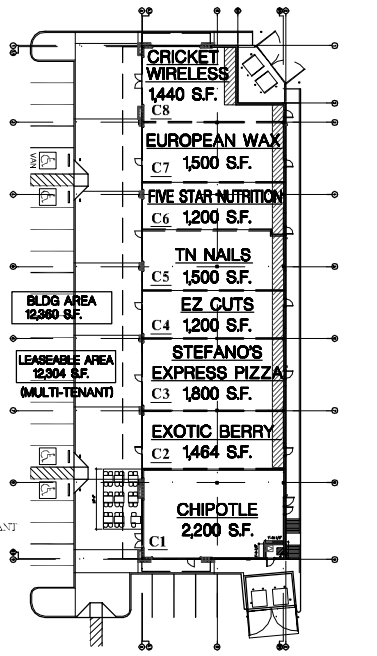

DETAILED FOOTPRINT
RETAIL #5
(BLDG 'C')

N. JACKSON ROAD

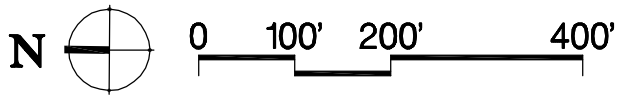

PHARR TOWN CENTER
PRELIMINARY SITE PLAN
N. JACKSON ROAD @ U.S. EXPRESSWAY 83
CITY OF PHARR, TEXAS
 2008-312.009 SP-317 06-04-2018

LEVINSON · ALCOSER
 ASSOCIATES, L.P.
 1177 W. Loop South, Suite 900 Houston, Texas 77027
 tel 713.787.0000 fax 713.850.8250
 Architecture • Planning • Engineering
 Interior Design • Landscape Architecture

LEVCOR