

W. POLK AVENUE

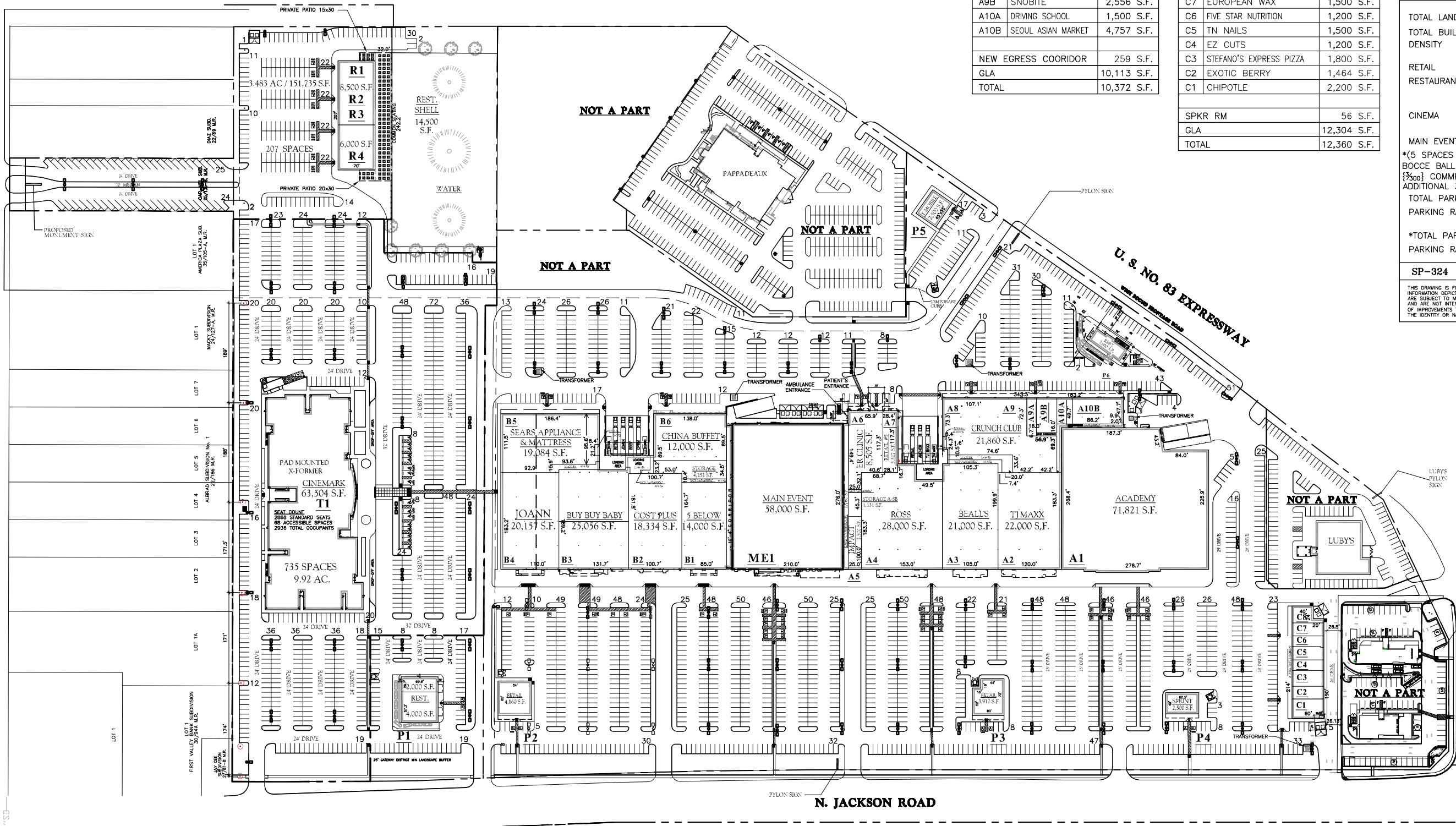

BUILDING 'A9' - 'A10' TOTALS		
A9A	10' HUT	1,300 S.F.
A9B	SNOBITE	2,556 S.F.
A10A	DRIVING SCHOOL	1,500 S.F.
A10B	SEOUL ASIAN MARKET	4,757 S.F.
NEW EGRESS COORIDOR 259 S.F.		
GLA		10,113 S.F.
TOTAL		10,372 S.F.

BUILDING 'C' TOTALS		
C8	CRICKET WIRELESS	1,440 S.F.
C7	EUROPEAN WAX	1,500 S.F.
C6	FIVE STAR NUTRITION	1,200 S.F.
C5	TN NAILS	1,500 S.F.
C4	EZ CUTS	1,200 S.F.
C3	STEFANO'S EXPRESS PIZZA	1,800 S.F.
C2	EXOTIC BERRY	1,464 S.F.
C1	CHIPOTLE	2,200 S.F.
SPKR RM 56 S.F.		
GLA		12,304 S.F.
TOTAL		12,360 S.F.

DEVELOPMENT SYNOPSIS REQUIREMENTS PER CITY OF PHARR, TEXAS			
TOTAL LAND AREA	(±48.60 AC.)	±2,117,295 S.F.	
TOTAL BUILDING AREA (GLA ONLY)		468,096 S.F.	
DENSITY		22.0 %	
RETAIL	305,328 S.F. (3 +1/300 S.F.)	1021 SPACES	
RESTAURANTS	41,264 S.F.		
	(1/100 S.F.)	413 SPACES	
CINEMA	63,504 S.F. (2,936 SEATS (1/4 SEATS))	734 SPACES	
MAIN EVENT	58,000 S.F.	476 SPACES	
* (5 SPACES PER LANE {28 BOWLING LANES AND 4 BOCCE BALL LANES}; PLUS 1/100 FOR RESTAURANT, 1/300 COMMERCIAL AND OFFICE; PLUS 1 FOR EACH ADDITIONAL 300 GFA)			
TOTAL PARKING REQUIRED		2,644 SPACES	
PARKING RATIO REQUIRED		5.6 /1000	
*TOTAL PARKING PROVIDED 2,644 SPACES			
PARKING RATIO PROVIDED		5.6 /1000	
SP-324 02 - 28 - 2019 2008-312.009			
THIS DRAWING IS FOR INFORMATION PURPOSES ONLY. ANY AND ALL FEATURES, MATTERS OTHER INFORMATION DEPICTED HEREON OR CONTAINED HEREIN ARE FOR ILLUSTRATIVE MARKETING PURPOSES ONLY, ARE SUBJECT TO MODIFICATION WITHOUT NOTICE, ARE NOT INTENDED TO BE RELIED UPON BY ANY PARTY AND ARE NOT INTENDED TO CONSTITUTE REPRESENTATIONS AND WARRANTIES AS TO THE SIZE AND NATURE OF IMPROVEMENTS TO BE CONSTRUCTED (OR THAT ANY IMPROVEMENTS WILL BE CONSTRUCTED) OR AS TO THE IDENTITY OR NATURE OF ANY OCCUPANTS THEREOF.			

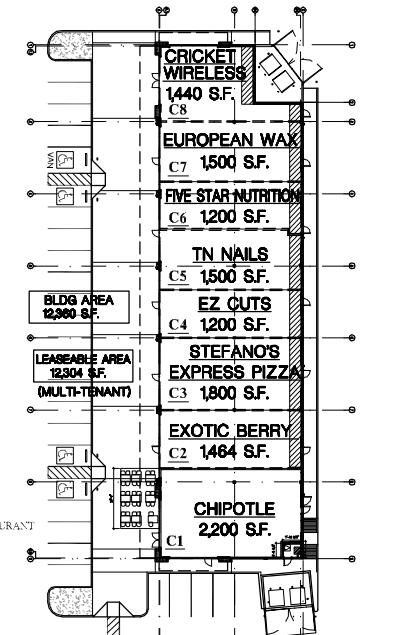

**DETAILED FOOTPRINT
RETAIL #5
(BLDG 'C')**

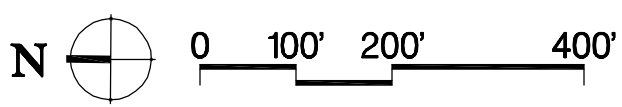

PHARR TOWN CENTER
PRELIMINARY SITE PLAN
N. JACKSON ROAD @ U.S. EXPRESSWAY 83
CITY OF PHARR, TEXAS
 2008-312.009 SP-324 02 - 28 - 2019